

KINSHOFER Rotator Line

KINSHOFER manufactures rotators for truck loaders, excavators and logging operations. Years of experience in designing rotators and hydraulic load handling equipment guarantee high efficiency, long lasting rotators, specially tailored to meet your requirements.

The gear-type design ensures a very compact and powerful rotator. The precision control and braking ability is especially appreciated by operators. A grapple does not rotate unexpectedly when digging, even under maximum load, and there is no need for stability compensation when handling longer lengths of timber... these are only some of the many working situations where operators appreciate the advantages of using **KINSHOFER** rotators.

KINSHOFER-Rotators are the solution.



Features of **KINSHOFER** Rotators

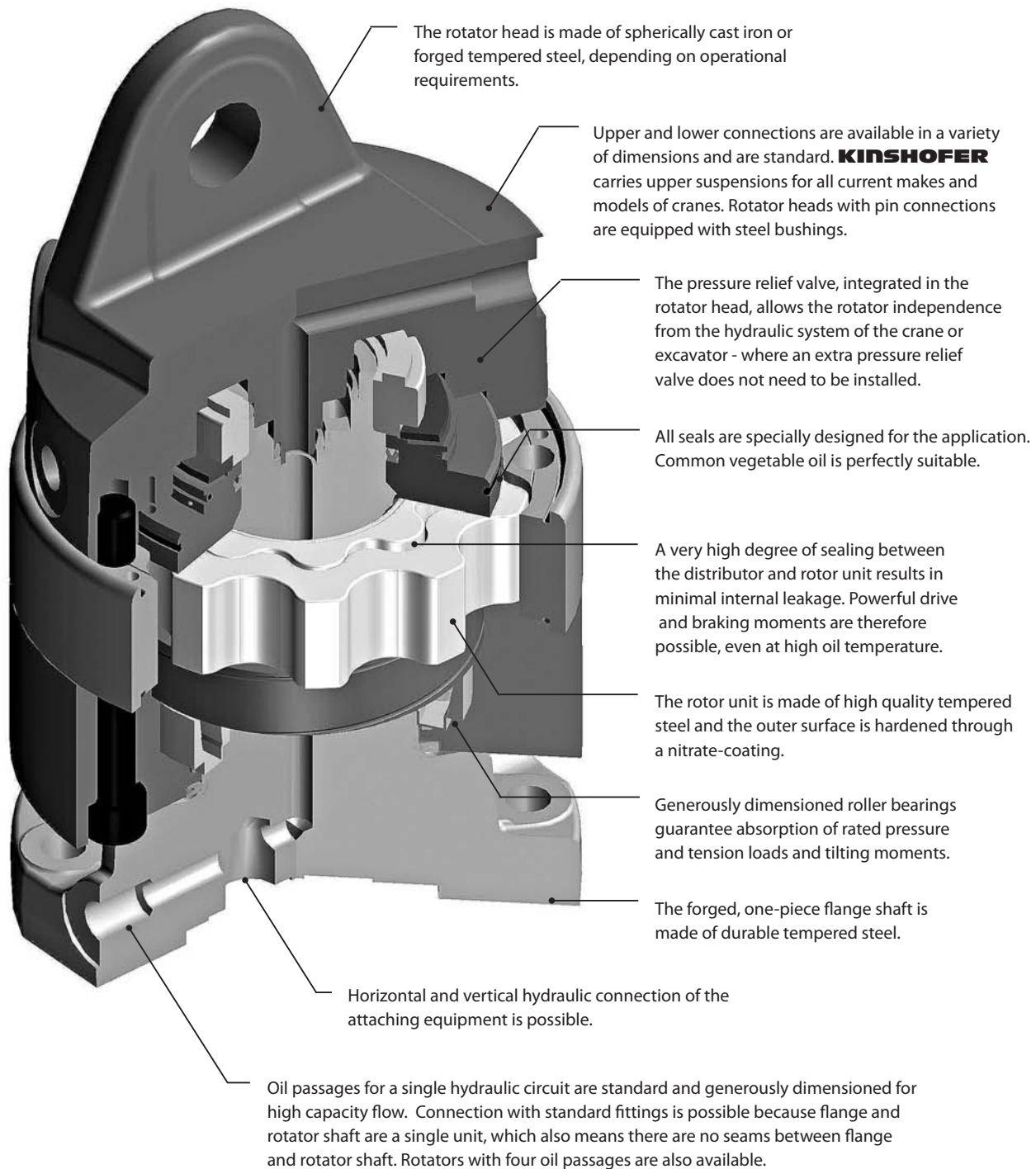

Product Range

KINSHOFER Rotator Line

Note concerning all rotators:

- upper and lower bearings are taper roller bearings
- all rotators come with JIC-fittings
- all rotators come with steel bushings in the head
- internal pressure relief valves, no port relief on crane necessary

KINSHOFER Gear type rotator with shaft up to 2000 kg/4400 lbs. load capacity

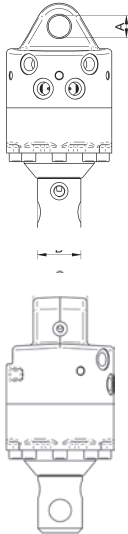

Type	Load capacity (kg/lbs.)	Shaft Ø B (mm/in)	Upper connection (Width C x Pin-Ø A) (mm/in)	Torque (ft.lbs.)	Moment of deflection max (ft.lbs.)	Self weight (lbs.)
KM 02 S	2000/4400	49.5/1.95	60 x 25 / 2.36 x 0.98	220	770	25
KM 02 S-N - w/o oil ducts	2000/4400	49.5/1.95	60 x 25 / 2.36 x 0.98	220	770	20
KM 02 S-H - with integrated hook w/o oil ducts	2000/4400	Hook	60 x 25 / 2.36 x 0.98	220	770	20



KM 02 S

Operating pressure: 3750 psi
Pump capacity: 6.5 to 13.0 GPM
Hydraulic couplings: G 3/8"

KINSHOFER Gear type rotator with shaft up to 4500 kg / 9900 lbs. load capacity

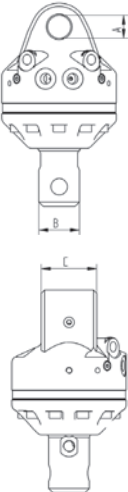

Type	Load capacity (kg/lbs.)	Shaft Ø B (mm/in)	Upper connection (Width C x Pin-Ø A) (mm/in)	Torque (ft.lbs.)	Moment of deflection max (ft.lbs.)	Self weight (lbs.)
KM 04 S59-30	4500/9900	59/2.32	84 x 30/3.31 x 1.18	630	2200	60
KM 04 S	4500/9900	62/2.44	84 x 30/3.31 x 1.18	630	2200	60
KM 04 S63-30	4500/9900	63/2.48	84 x 30/3.31 x 1.18	630	2200	60
KM 04 S68-30	4500/9900	68/2.68	84 x 30/3.31 x 1.18	630	2200	60
KM 04 S69-30	4500/9900	69/2.72	84 x 30/3.31 x 1.18	630	2200	60
KM 04 S68-30US*	4500/9900	68/2.68	84 x 30/3.31 x 1.18	740	3300	75



KM 04 S

* steel motor-head

Operating pressure: 4600 psi
Pump capacity: 6.5 to 16.0 GPM
Hydraulic couplings: M 18 x 1.5

KINSHOFER Gear type rotator with flange up to 4500 kg / 9900 lbs. load capacity

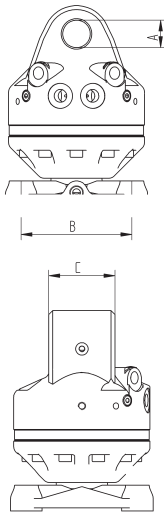

Type	Load capacity (kg/lbs.)	Hole pattern of flange B (mm/in)	Upper connection (Width C x Pin-Ø A) (mm/in)	Torque (ft.lbs.)	Moment of deflection max (ft.lbs.)	Self weight (lbs.)
KM 04 F	4500/9900	140/ 5.51	84 x 30/3.31 x 1.18	630	2200	60
KM 04 F140-30US*	4500/9900	140/ 5.51	84 x 30/3.31 x 1.18	740	6200	70



KM 04 F

* steel motor-head

Operating pressure: 4600 psi
Pump capacity: 6.5 to 16.0 GPM
Hydraulic couplings: M 18 x 1.5



KM 04 F140US

We reserve the right to amend specifications without prior notice. **KINSHOFER** GmbH, 83666 Waakirchen, Germany

KINSHOFER Rotator Line

Product Range

KINSHOFER Gear type rotator with shaft up to 6000 kg / 13200 lbs. load capacity

Type	Load capacity (kg/lbs.)	Shaft Ø B (mm/in)	Upper connection (Width C x Pin-Ø A) (mm/in)	Torque (ft.lbs.)	Moment of deflection max (ft.lbs.)	Self weight (lbs.)
KM 06 S68-40	6000/13200	68/2.68	84 x 40/3.31 x 1.57	740	3300	70

Operating pressure: 4600 psi
 Pump capacity: 6.5 to 21.0 GPM
 Hydraulic couplings - in: G 1/2"
 Hydraulic couplings - out: M 18 x 1.5



KINSHOFER Gear type rotator with flange up to 18000 kg / 39600 lbs. load capacity

Type	Load capacity (kg/lbs.)	Hole pattern of flange B (mm/in)	Upper connection (Width C x Pin-Ø A) (mm/in)	Torque (ft.lbs.)	Moment of deflection max (ft.lbs.)	Self weight (lbs.)
KM 06 F140-40	6000/13200	140/ 5.51	84 x 40/3.31 x 1.57	740	6300	75
KM 07 F180-40	7000/15400	180/ 7.09	84 x 40/3.31 x 1.57	1480	11100	285
KM 10 F180-50	10000/22000	180/ 7.09	110 x 50/4.33 x 1.97	1480	11100	165
KM 12 F180-50	12000/26400	180/ 7.09	110 x 50/4.33 x 1.97	1110	8900	165
KM 18 F275-60	18000/39600	Ø275/Ø10.83	125 x 60/4.92 x 2.36	1480	18400	155

Operating pressure: 4600 psi
 Pump capacity: 6.5 to 21.0 GPM
 Hydraulic couplings - in: G 1/2"
 Hydraulic couplings - out: M 18 x 1.5



KM 06 F140-40

KINSHOFER Gear type rotator with flange and 4 oil ducts to operate 2 different functions

Type	Load capacity (kg/lbs.)	Hole pattern of flange B (mm/in)	Upper connection (Width C x Pin-Ø A) (mm/in)	Torque (ft.lbs.)	Moment of deflection max (ft.lbs.)	Self weight (lbs.)
KM 04 F140-30-4	4500/9900	140/ 5.51	84 x 30/3.31 x 1.18	630	2200	90
KM 06 F173-35-4	6000/13200	Ø173/Ø6.81	81 x 35/3.19 x 1.38	740	6300	100
KM 10 F173-35/2-4	10000/22000	Ø173/Ø6.81	81 x 35/3.19 x 1.38	1480	8900	160

	KM 04 F140-30-4	KM 06 F173-35-4	KM 10 F173-35/2-4
Operating pressure:	4600 psi	4600 psi	4600 psi
Pump capacity:	6.5 to 16.0 GPM	6.5 to 26.0 GPM	6.5 to 26.0 GPM
Hydraulic couplings (Rotator and Grapple):	M 18 x 1.5	G 1/2"	G 1/2" and G 3/4"



KM 04 F140-30-4

KINSHOFER Gear type rotator with flange for logging (incl. hose guard)

Type	Load capacity (kg/lbs.)	Hole pattern of flange B (mm/in)	Upper connection (Width C x Pin-Ø A) (mm/in)	Torque (ft.lbs.)	Moment of deflection max (ft.lbs.)	Self weight (lbs.)
KM 06F 173-35	6000/13200	Ø173/Ø6.81	81 x 35/3.19 x 1.38	740	6300	60
KM 10F 173-35/1	10000/22000	Ø173/Ø6.81	81 x 35/3.19 x 1.38	1480	8900	135
KM 10F 173-35/2	10000/22000	Ø173/Ø6.81	81 x 35/3.19 x 1.38	1480	8900	145
KM 10F 173-45	10000/22000	Ø173/Ø6.81	100 x 45/3.94 x 1.77	1480	8900	145
KM 10F 173-52	10000/22000	Ø173/Ø6.81	136 x 52.2/5.35 x 2.06	1480	8900	150

Operating pressure: 4600 psi
 Pump capacity: 6.5 to 26.0 GPM
 Hydraulic couplings
(Rotator and Grapple): G 1/2"



KM 10F 173-35/1

Accessories for Rotators

KINSHOFER Rotator Line

KM 501 - Upper Suspension between Rotator and Crane



KM 501

An upper suspension is a cardan link between rotator and crane. It is available for all current makes and models of cranes. Please specify dimensions when ordering.

Load capacity (lbs.)	Self weight (approx. lbs.)
up to 4400	10
up to 9900	20
up to 13200	30
up to 15400	40
up to 22000	55



KM 501

KM 511 - Upper Suspension with Pendulum Damper between Rotator and Crane



KM 511

A pendulum damper reduces the horizontal swing of the attachment. It can also be retrofitted to an existing upper suspension.

Load capacity (lbs.)	Self weight (approx. lbs.)
up to 9900	30
up to 13200	45
up to 15400	55
up to 22000	70

KM 206 - Hose Guard



The hose guard is a metal bow to be attached onto the rotator. It is designed to protect the hoses of the rotator from damage i.e. from protruding branches.

hose guard for the rotator

KM 502 - Reduction Link between Rotator and Grapple



KM 502

A reduction link adapts a shaft-type rotator to an attachment with a standard hole pattern for a flange.

Load capacity (lbs.)	Self weight (approx. lbs.)
up to 4400	4
up to 9900	7



KM 502



KM 502

KINSHOFER Rotator Line

Accessories for Rotators

KM 505 - Quick Change System for Shaft-Type Rotators

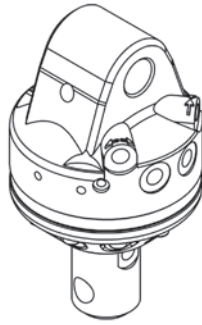

The quick change system enables an easy exchange between different attachments. The mechanical coupling and locking is achieved by the turning motion of the rotator. You simply disconnect quick couplings and disengage the locking device manually. Upper elements of the quick-change system are available for all **KINSHOFER** shaft rotators. The KM 505 system can be used on most attachments which allows the versatility to quickly change the application with a minimum of down-time. Not suitable for heavy duty work.

Type	Description	Shaft Ø	Connection bottom	Self weight
		(mm/in)	(mm/in)	(approx.) (lbs.)
KM 505	complete, incl. hydraulic couplings	62/2.44	Ø 140x18/Ø 5.51x0.70	35
KM 505	complete, incl. hydraulic couplings	68/2.68	Ø 140x18/Ø 5.51x0.70	35
KM 505 01	upper element fitted to rotator	62/2.44		10
KM 505 01	upper element fitted to rotator	68/2.68		10
KM 204 01	mobile part of hydraulic quick coupling (2 pieces) for KM 505 01			10
KM 505 02	lower element mounted onto attachment		Ø 140x18/Ø 5.51x0.70	15
KM 505 03	rigid suspension link with non rotating hook to connect to the KM 505 01 e.g. for attaching crane forks			15

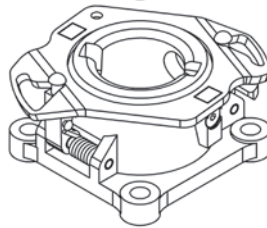
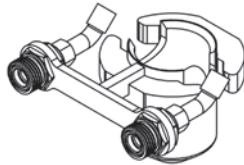

KM 505 01



KM 505 02



KM 505 03

KM 203 - Connecting Hoses & KM 204 - Hydraulic Quick Change Kit for Hoses

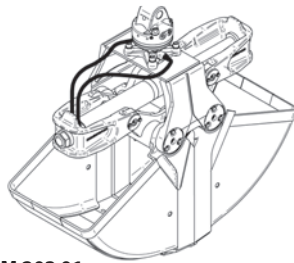

KM 203 01



KM 204 01

KM 204 02

Type	Description
KM 203 01	short connecting hoses between rotator and attachment with standard fittings M 18 x 1,5 (2 pieces)
KM 203 03	long connecting hoses between rotator and crane - please specify dimensions (4 pieces)

KM 204 01	mobile part of hydraulic quick coupling for hose (Ø 0.39 in, 2 pieces)
KM 204 02	fixed part of hydraulic quick coupling for rotator (Ø 0.39 in, 2 pieces)
KM 204 03	hydraulic quick change kit incl. mobile and fixed parts (2 pieces each) mounted with adapters to rotator

Accessories for attaching Pallet Forks etc.



KM 460 03



KM 460 04

Type	Description	Load capacity (kg / lbs.)	Self weight (approx. lbs.)
KM 460 03	rigid suspension link with pin for KINSHOFER shaft rotators	4500/9900	20
KM 460 02	non rotating hook for KINSHOFER shaft rotators	2000/4400	20
KM 460 04	non rotating hook for KINSHOFER shaft rotators	4500/9900	30
KM 460 05	non rotating hook for KINSHOFER shaft rotators	5000/11100	40
KM 460 06	non rotating hook for KINSHOFER shaft rotators	6000/13200	40
KM 460 10	non rotating hook for KINSHOFER shaft rotators	10000/22000	60